

Calapooia

Bond Promise – Applied Learning

Square Footage

Bond Promise

| | |
|--------------|--------|
| Classroom 13 | 875 sf |
| Classroom 14 | 857 sf |

Proposed Design

| | |
|--------------|----------|
| Classroom 03 | 1,664 sf |
|--------------|----------|

| | |
|------------|---------|
| Difference | - 86 sf |
|------------|---------|

Scope

Bond Promise

- Classroom 13 – Applied Learning
- Classroom 14 – Applied Learning
- Doors between classrooms and to courtyard
- Windows into Hallway

Proposed Design

- Classroom 3 - Applied Learning
- Small group learning
- AVID Classes
- New windows into hallway

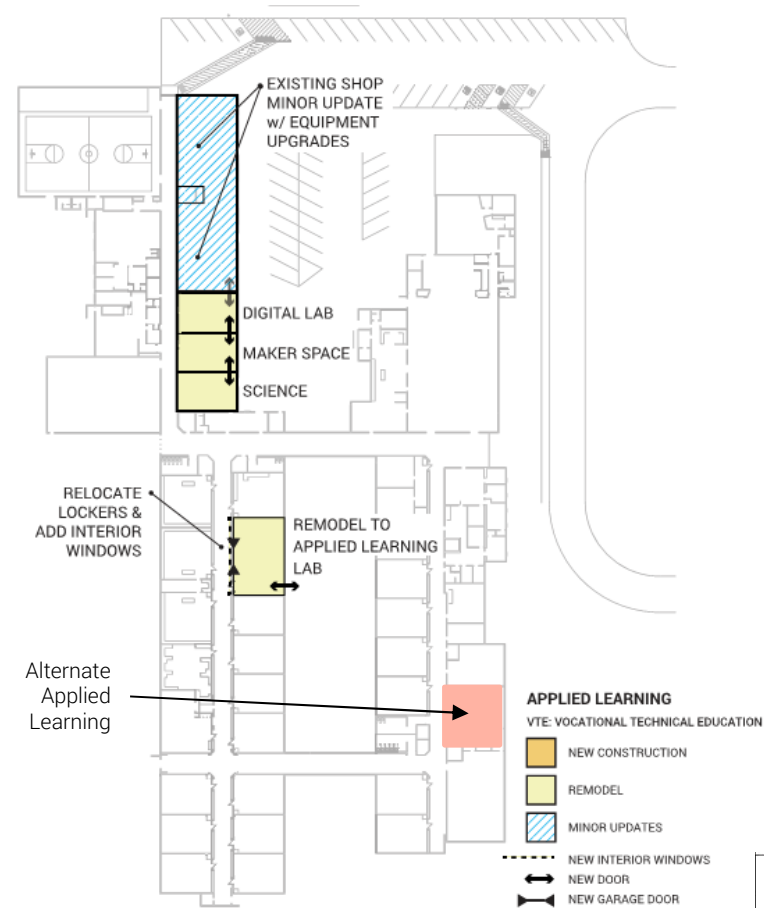

Alternate Applied Learning

APPLIED LEARNING

VTE: VOCATIONAL TECHNICAL EDUCATION

NEW CONSTRUCTION

REMODEL

MINOR UPDATES

NEW INTERIOR WINDOWS

NEW DOOR

NEW GARAGE DOOR

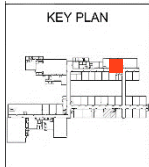

Calapooia

New Media Lab – Add Alternate

Bond Promise

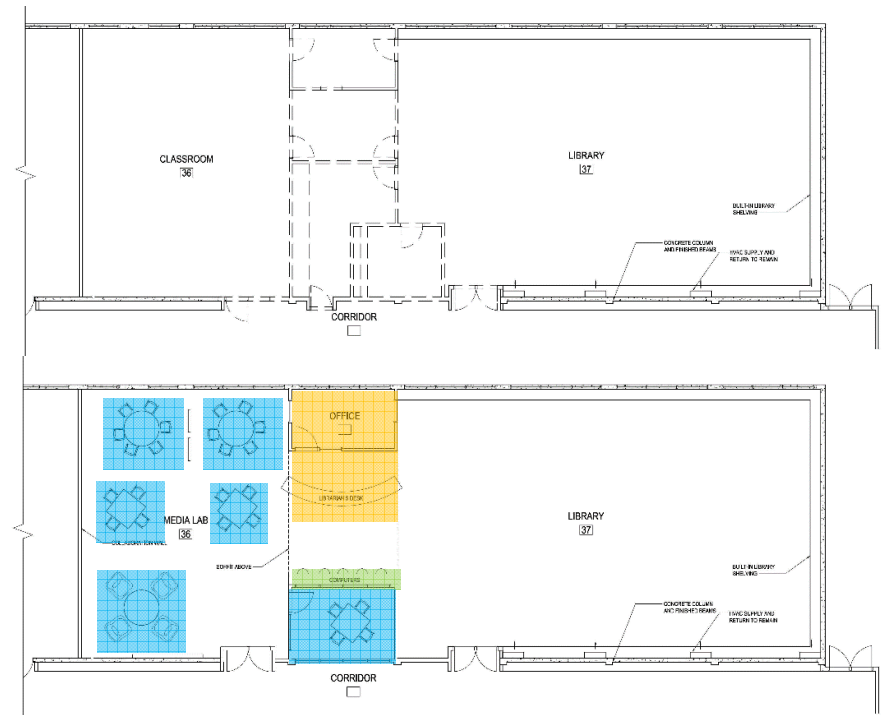
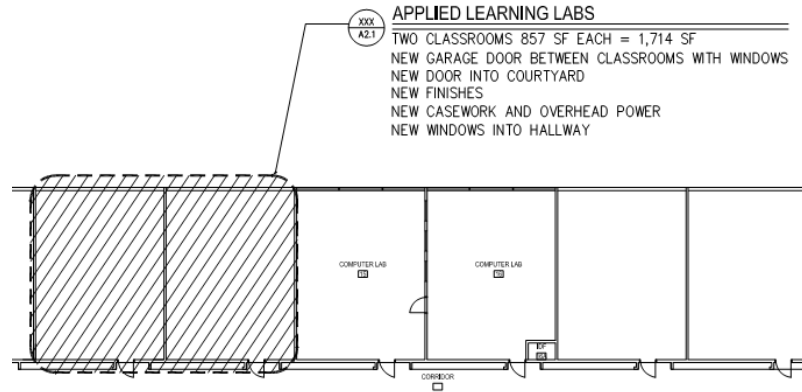

MEDIA LAB - PROPOSED PLAN

- Key
- Librarian Area
 - Work Stations
 - Collaboration

