



NORTH ALBANY MIDDLE SCHOOL

3705 SE COLUMBUS STREET, ALBANY, OR 97322

STUDENT POPULATION: 510 YEAR BUILT: 1966 EXISTING BUILDING AREA: 82,529 SF

VTE PROPOSAL

Total Renovated Square Footage.....6,000 SF

APPLIED LEARNING

VTE: VOCATIONAL TECHNICAL EDUCATION

- NEW CONSTRUCTION
- REMODEL
- MINOR UPDATES

- NEW INTERIOR WINDOWS
- NEW DOOR
- NEW GARAGE DOOR

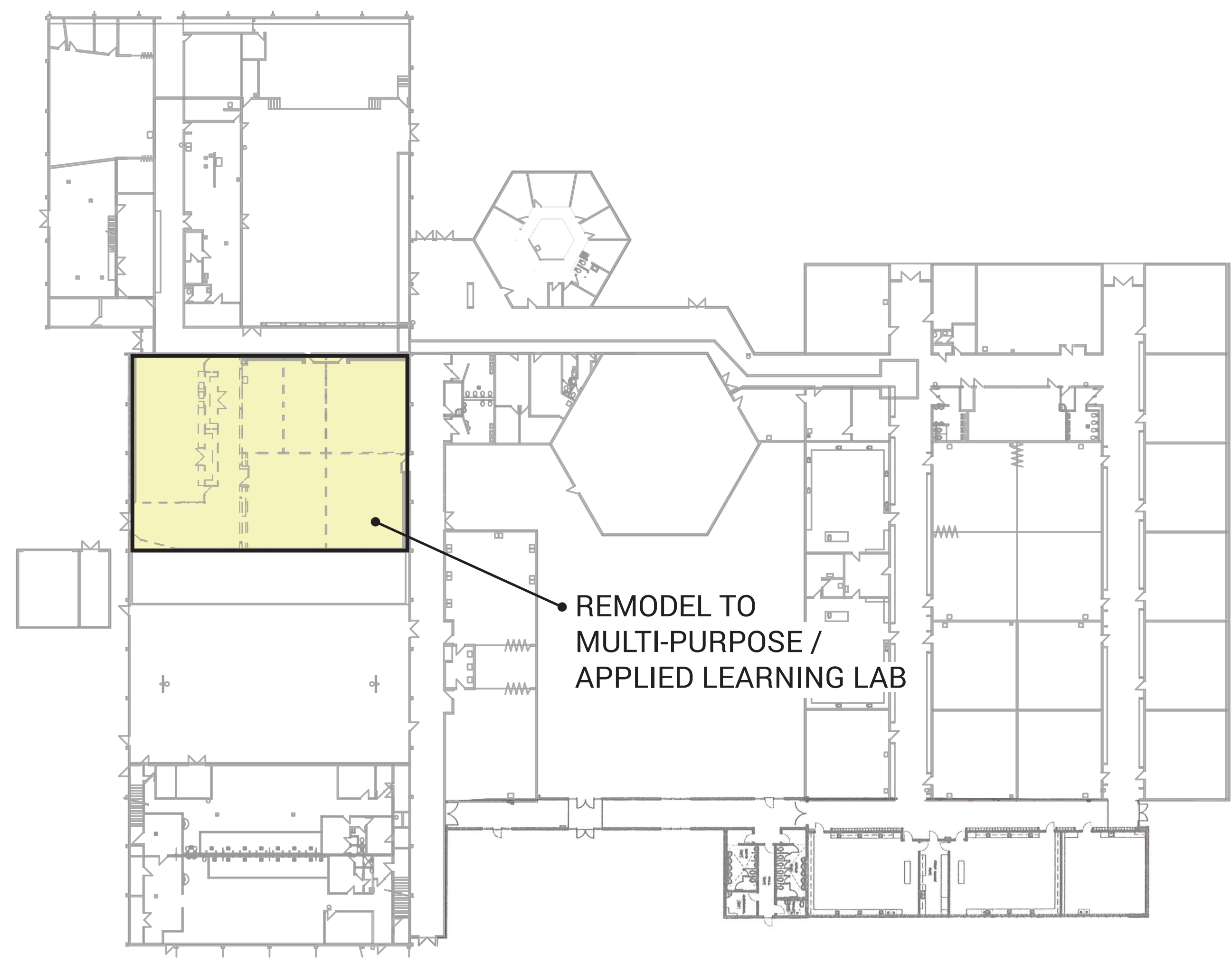

Greater Albany Public Schools

BALLOT MEASURE 22-165 May 16, 2017

Bonds for School, Energy/Safety Upgrades, HS Renovations / Vocational Education

Q: *Shall Greater Albany Public Schools make energy, safety, school renovations, add classrooms, vocational education, by issuing \$159,000,000 general obligation bonds?*

THIS BOND MEASURE WOULD BENEFIT ALL SCHOOLS.

- Make critical facility upgrades and improvements, including replacing roofs, siding, windows, plumbing, and electrical systems.
- Make energy improvements, including replacing old, inefficient high maintenance heating/ventilation systems, and doors.
- Make safety/security upgrades, including automatic door locks, fire alarms, and security cameras.
- Make seismic upgrades to enable buildings to better withstand earthquakes.
- Renovate and/or add classroom space to support vocational/technical classes at all middle school buildings.
- Renovate, add classrooms and cafeteria at Oak Grove Elementary School; purchase property and construct, equip and furnish a new elementary school in NE Albany to address growing enrollment.
- Construct, equip and furnish the first phase of West Albany High School's rebuild and multipurpose vocational education and gymnasium space at South Albany High School.

If approved, the 20-year \$159 million proposed bond is estimated to cost \$2.35 per \$1,000 of assessed property value, which is an increase of \$.64 per \$1,000 of assessed property value more than taxpayers have been paying.

FOR MORE INFORMATION:

GREATER ALBANY PUBLIC SCHOOLS
VISIT: www.albany.k12.or.us/bondinfo
EMAIL: info@albany.k12.or.us
CALL: GAPS District Office: 541.967.4501